

# GAS BARBECUE

XENON 223, 225, 227 AND 229 MODELS.

**grandhall**  
living style

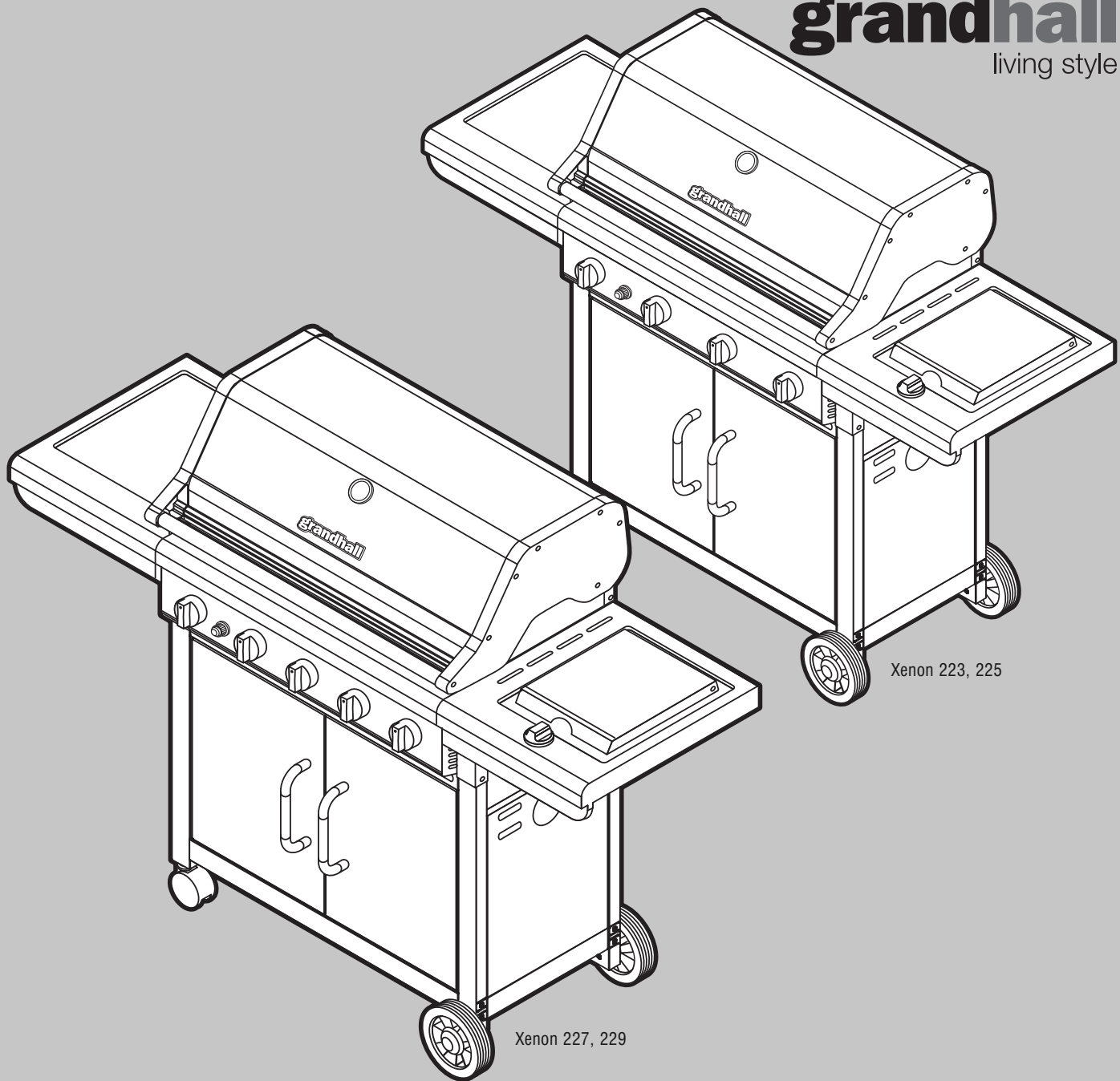

**IE GB** Assembly instructions

**CH FR** Instructions d'assemblage

**AT CH DE** Montageanweisungen

**CH IT** Istruzioni per il montaggio

**LU BE NL** Montage-instructies

**SE** Montering

**FI** Kokoamisohjeet

**ES** Instrucciones de armado

**PT** Instruções para Montagem

**DK** Monteringsvejledning

**NO** Montering

**PL** Instrukcje

**CE** 0087

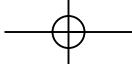

**ASSEMBLY**

①

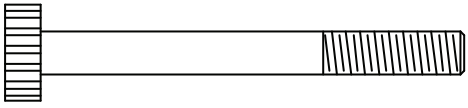

Pattern-head screw, part threaded 1/4" x 2<sup>3</sup>/<sub>8</sub>"  
Qty: 4

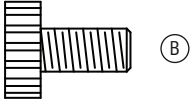

Pattern-head screw 1/4" x 1/2"  
Qty: 4

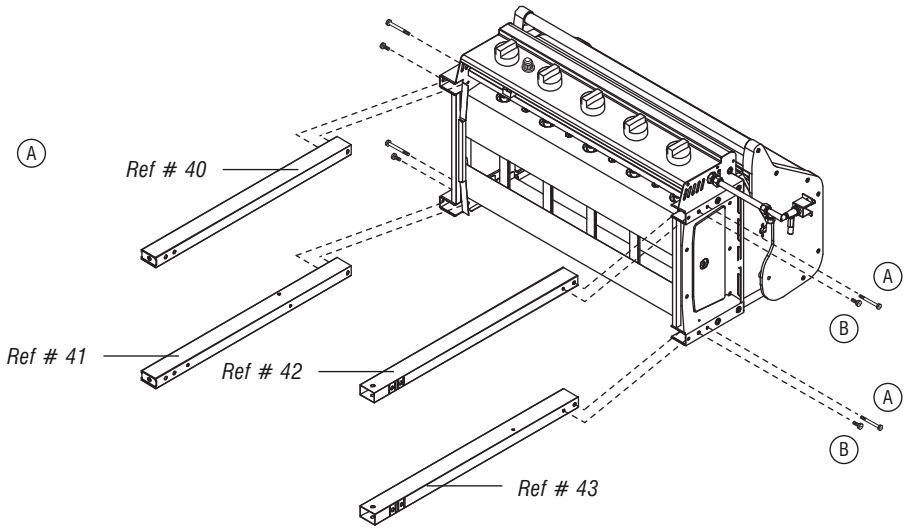

②

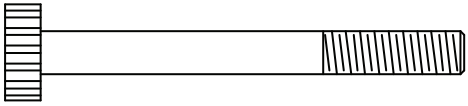

Pattern-head screw, part threaded 1/4" x 2<sup>3</sup>/<sub>8</sub>"  
Qty: 8

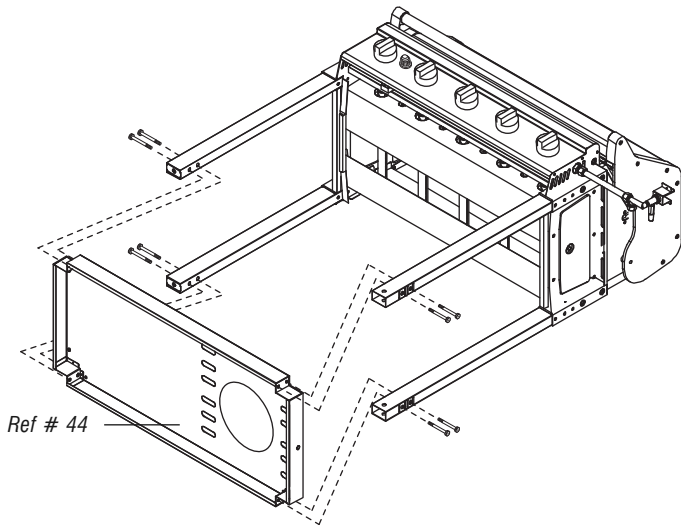

②

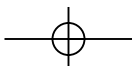

3

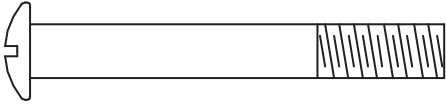

Wheel bolt 3/8" x 3 3/8"  
Qty: 2



Spring washer 3/8"  
Qty: 2



Lock nut 3/8"  
Qty: 2

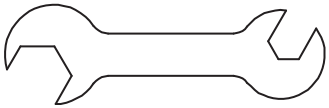

Customised spanner

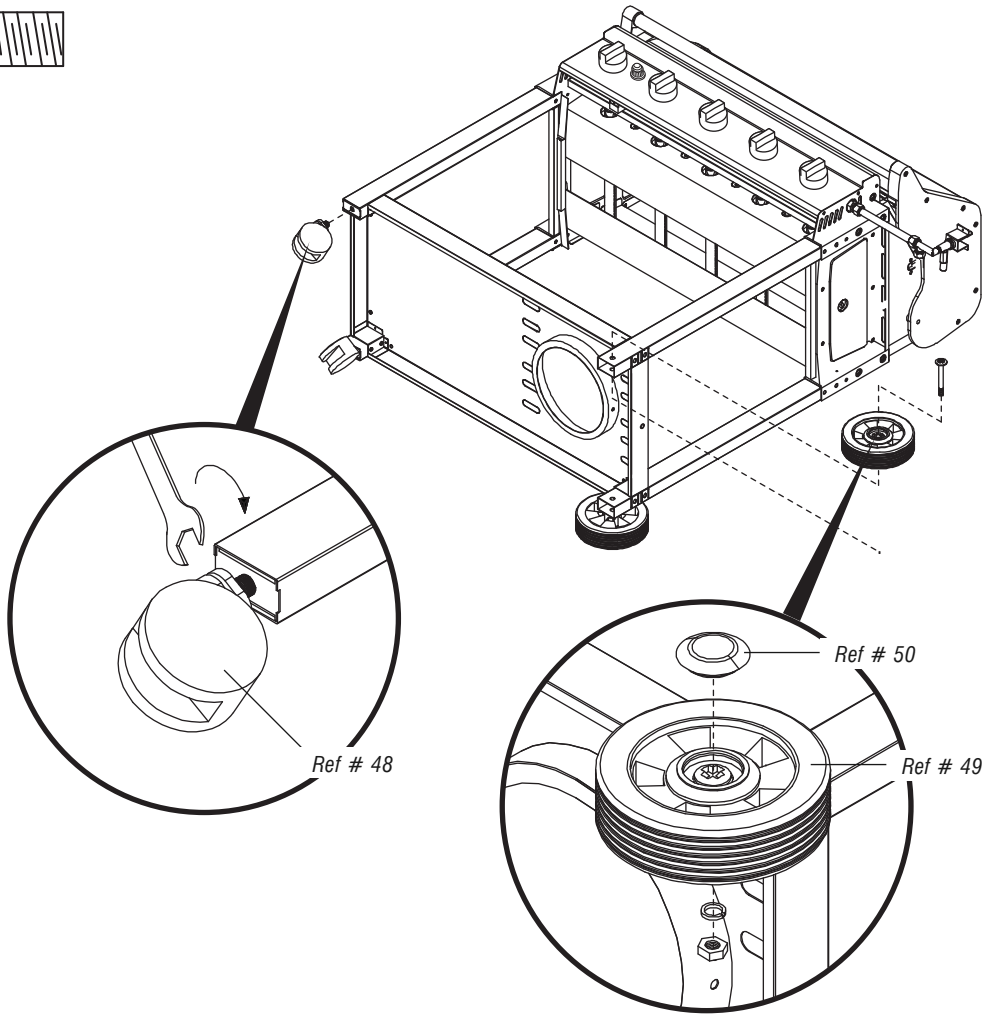

4

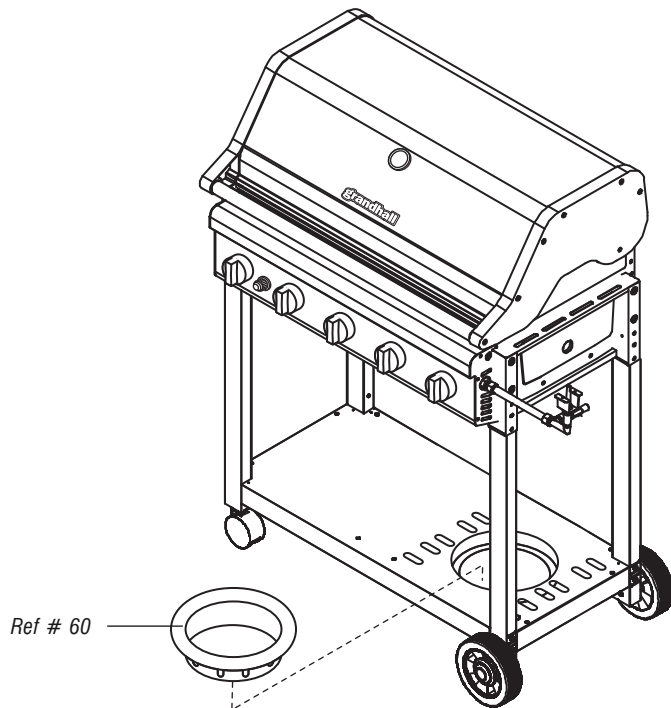

3

5

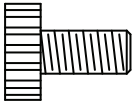

Pattern-head screw 1/4" x 1/2"  
Qty: 10

Ref # 45

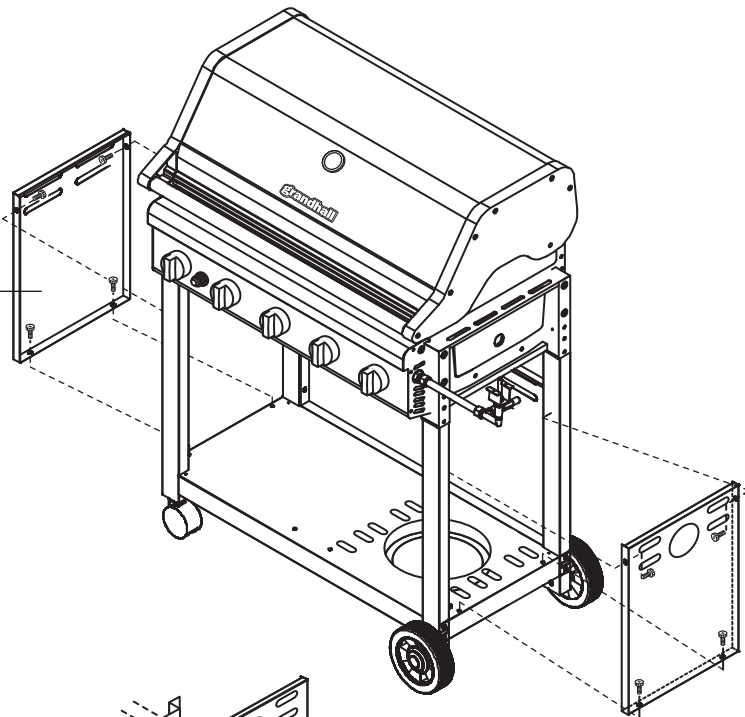

2ND

Ref # 61

Ref # 46

1ST

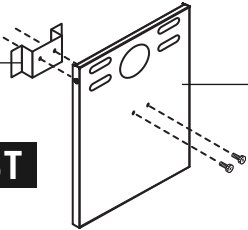

6

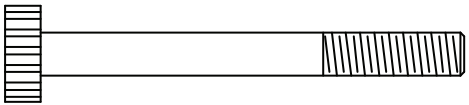

Pattern-head screw, part threaded 1/4" x 2 3/8"  
Qty: 2



Pattern-head screw 1/4" x 1/2"  
Qty: 6

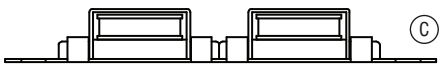

Magnetic door stop  
Qty: 2

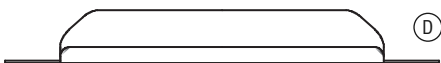

Door stop plate  
Qty: 1 Scale: 1:2

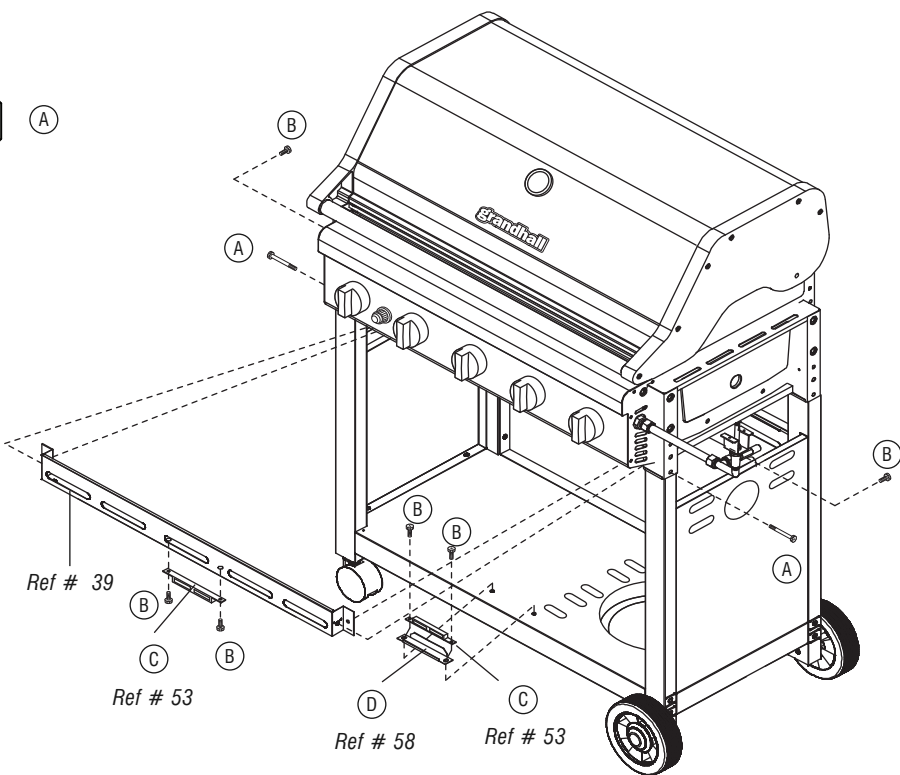

Ref # 39

Ref # 53

Ref # 58

Ref # 53

4

7

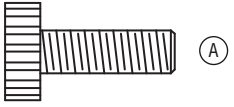

Pattern-head screw  $1/4" \times 3/4"$  – stainless steel  
Qty: 4

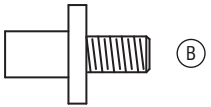

Door hinge pin  $1/4" \times 3/8"$   
Qty: 2

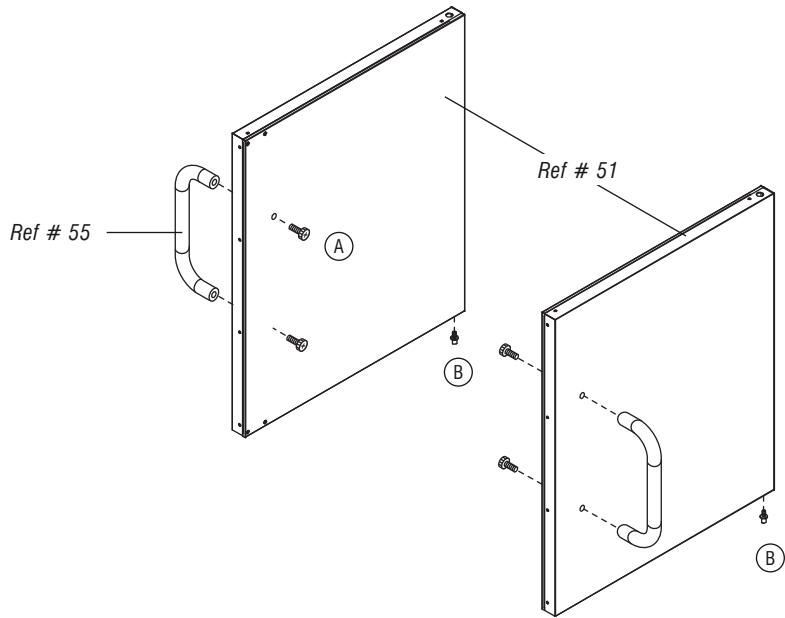

8

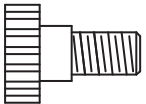

Pattern-head screw – part threaded  $1/4" \times 5/8"$   
Qty: 2

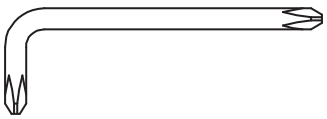

L-screwdriver

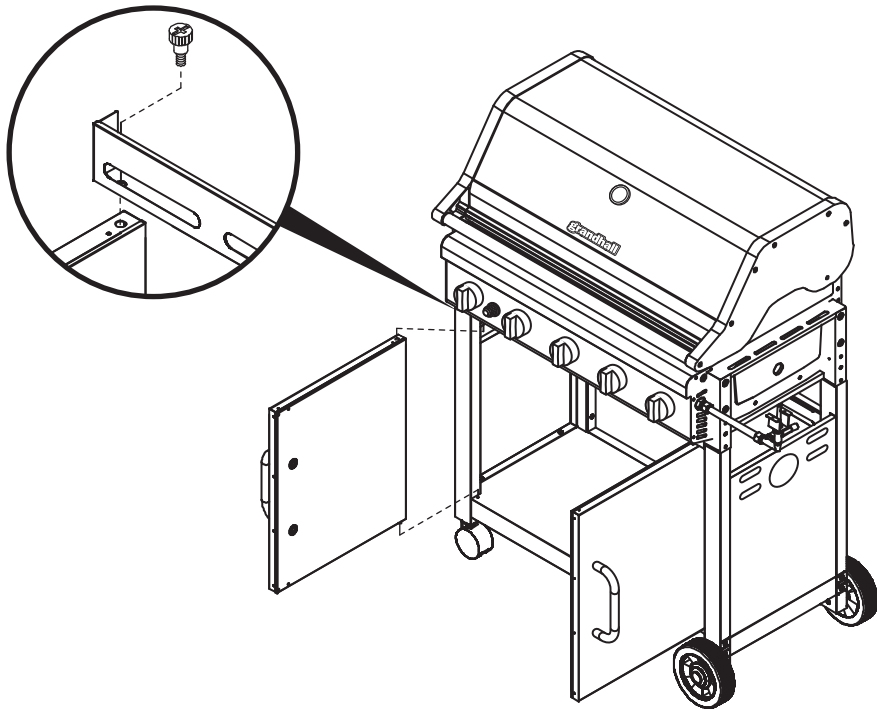

5

9

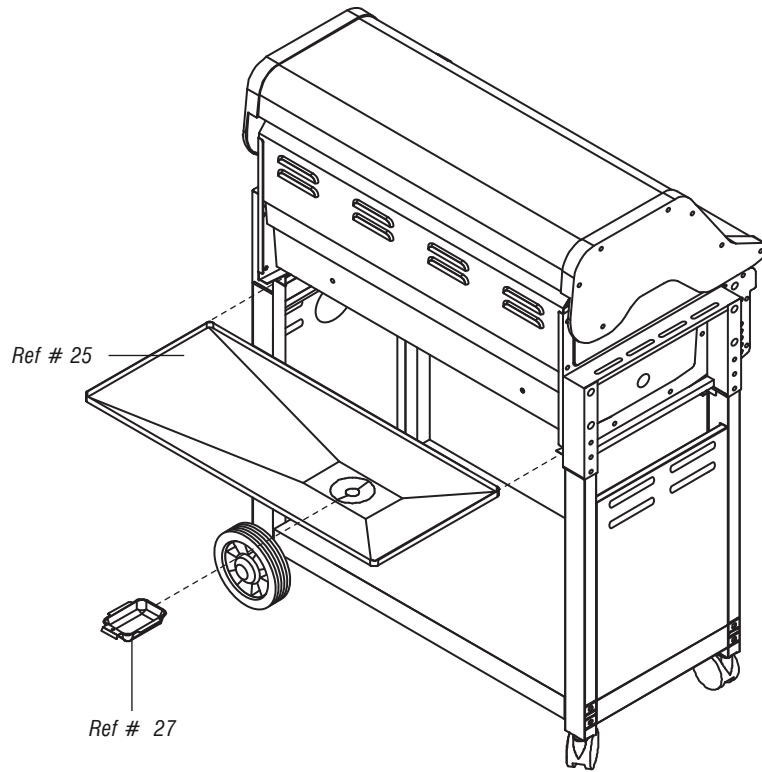

10

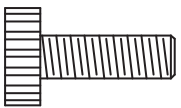

Pattern-head screw 1/4" x 3/4" - black  
Qty: 10

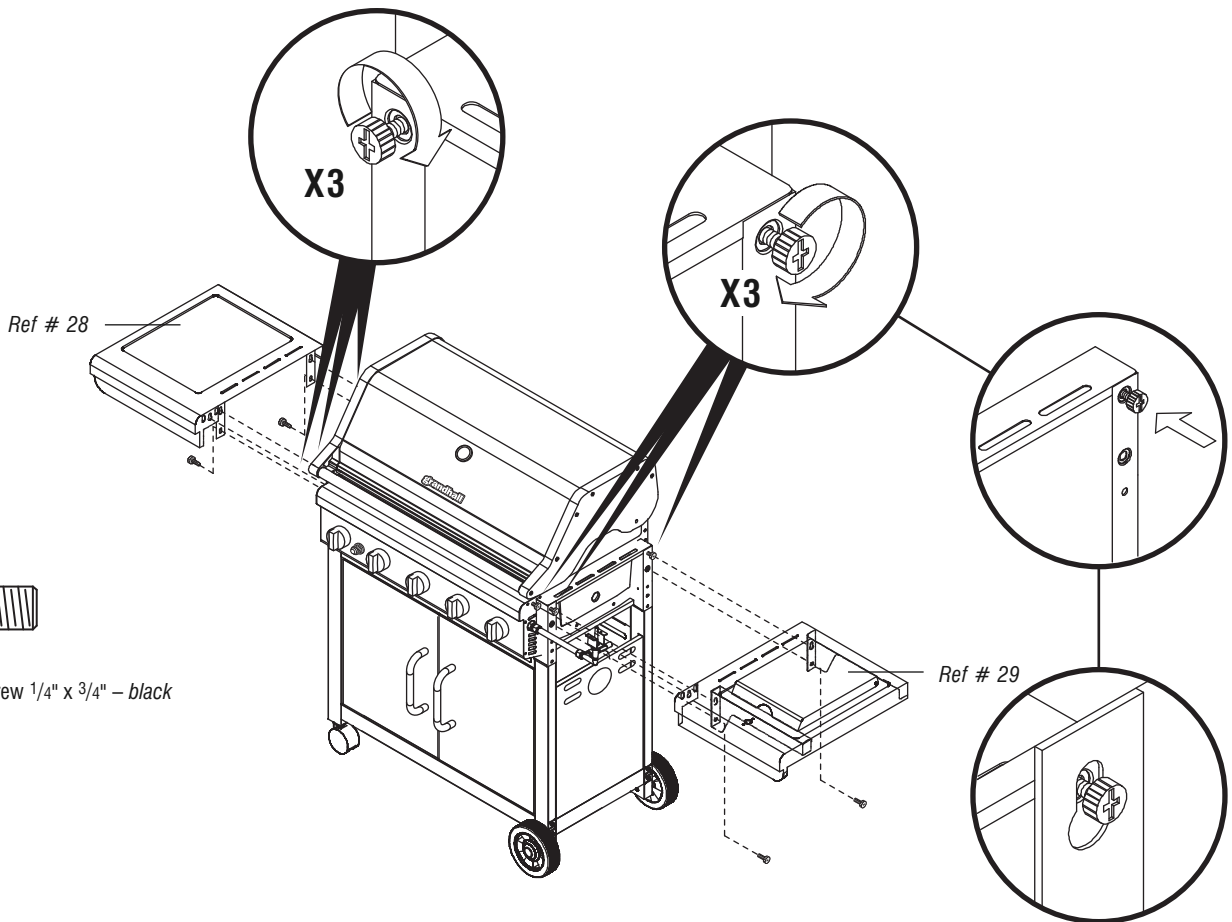

6

11

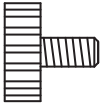

Pattern-head screw M4 x 8 mm  
Qty: 2

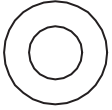

Plain washer M4  
Qty: 2

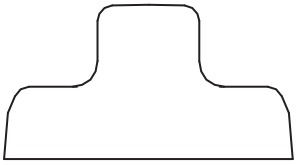

Control knob - Ref # 31  
Qty: 1



Cotter pin  
Qty: 1



Fastening band  
Qty: 1

5TH

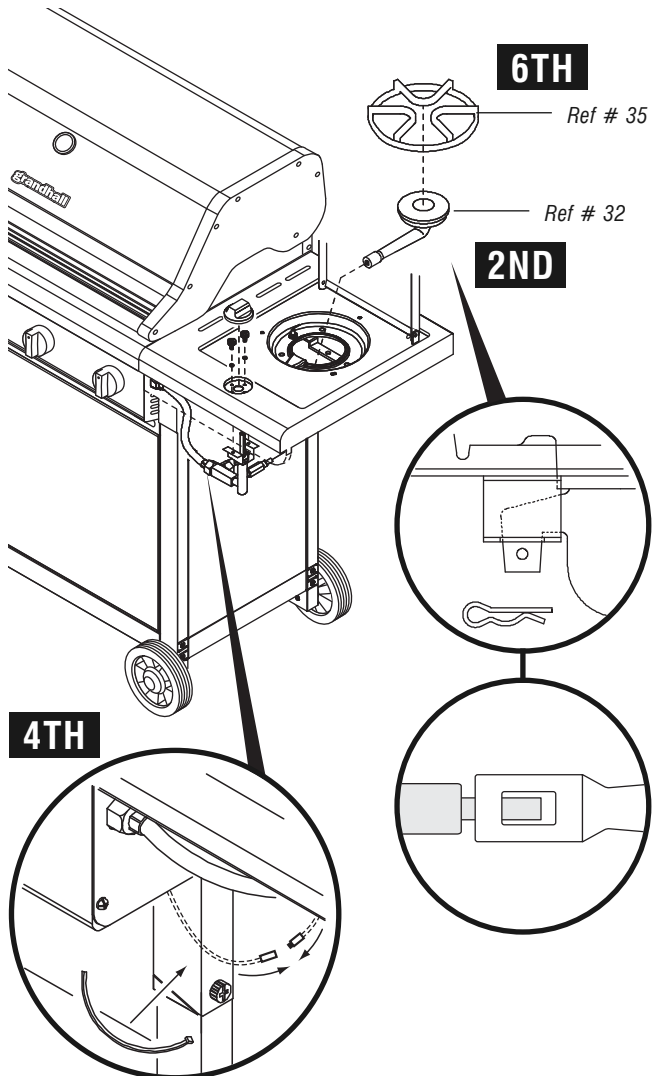
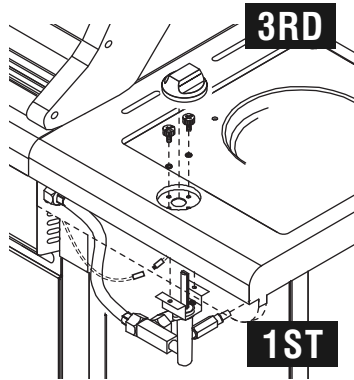
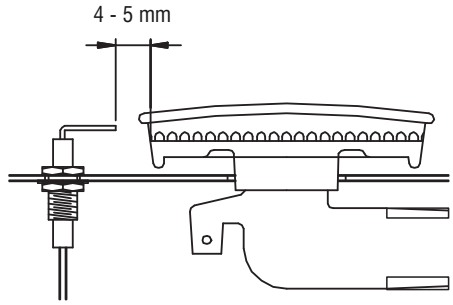

**CONNECTION AND TESTING OF  
GAS CONNECTION**

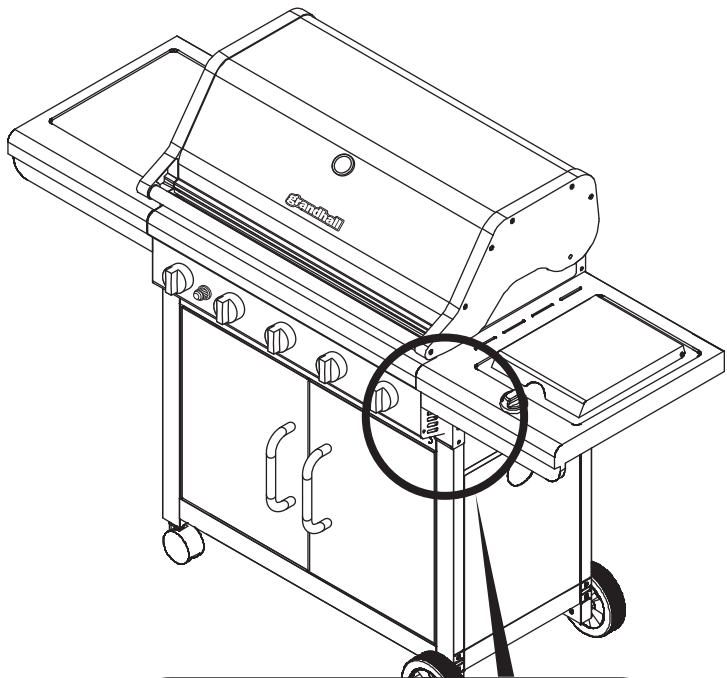

1

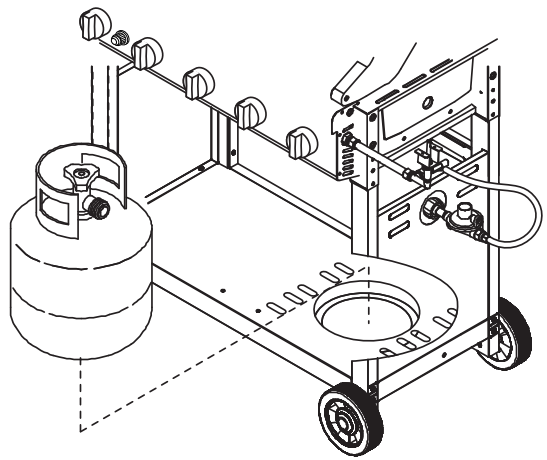

2

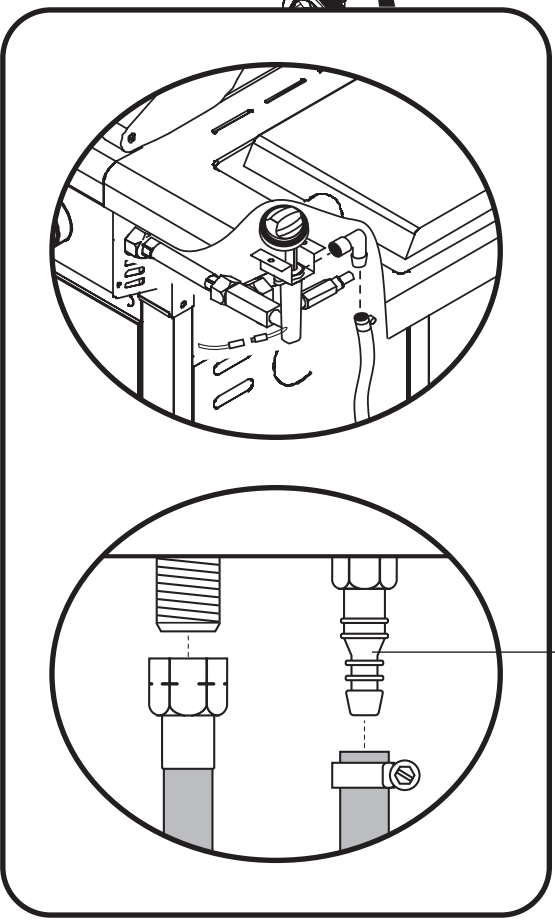
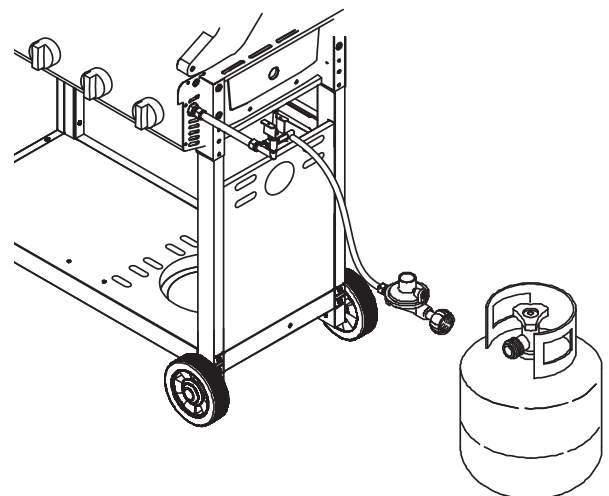

Ref # 62

8



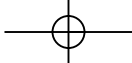

### IGNITION BATTERY

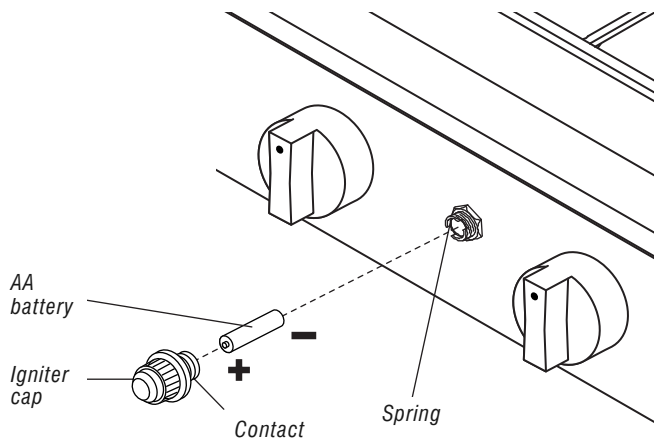

### LIGHT BBQ WITH MATCH

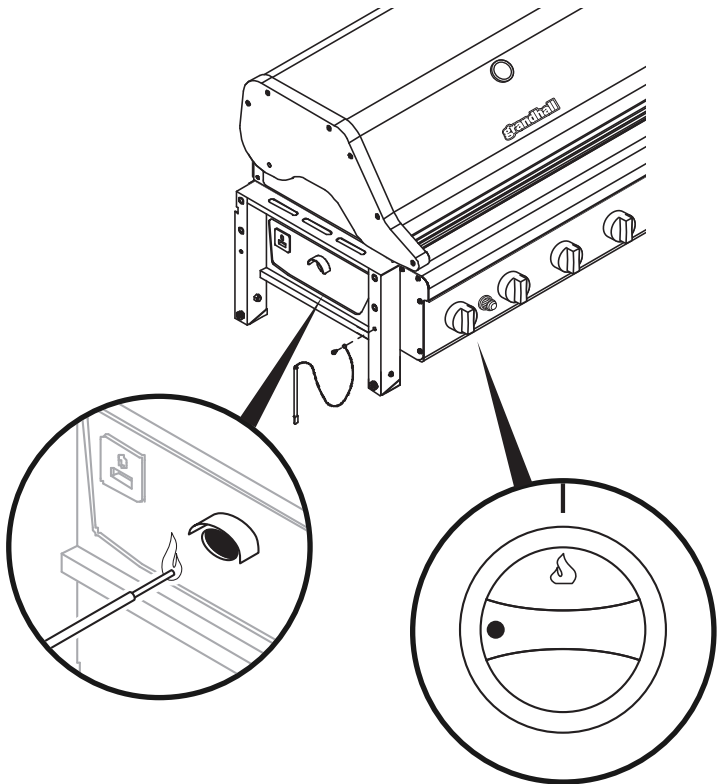

### COOKING COMPONENT INSTALLATION

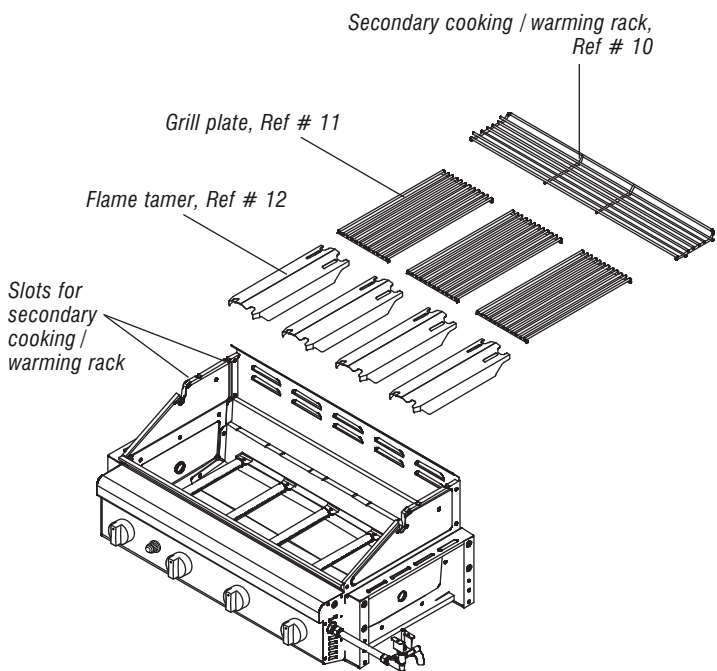

Xenon 223, 225

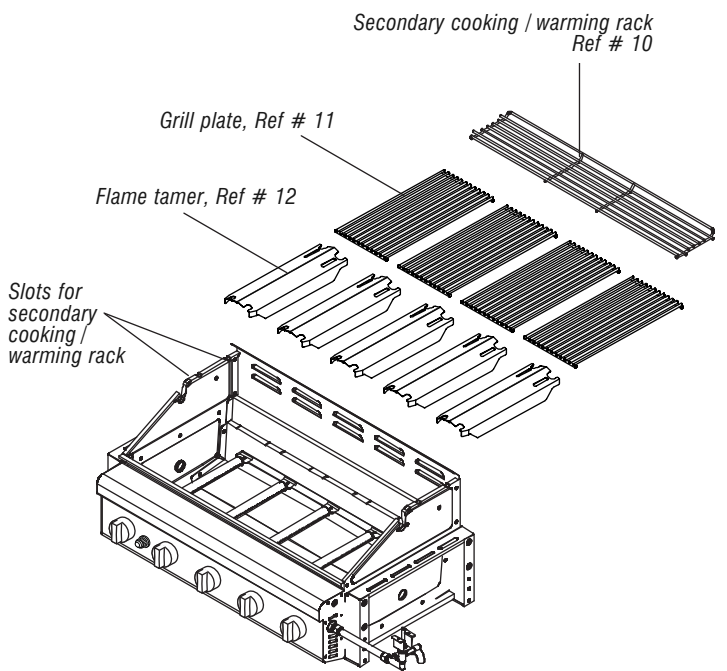

Xenon 227, 229

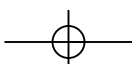

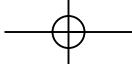

### MAIN / SIDE BURNER OPERATION

Xenon 223, 225

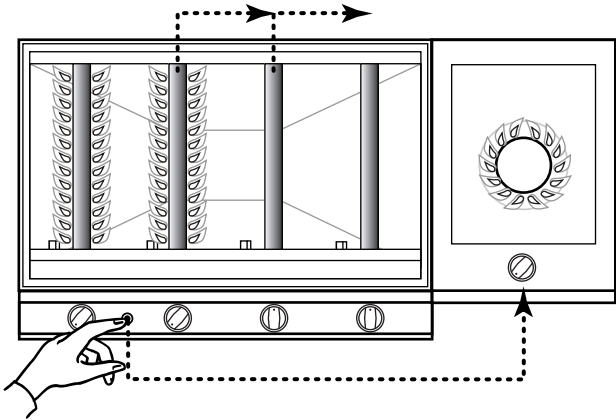

Xenon 227, 229

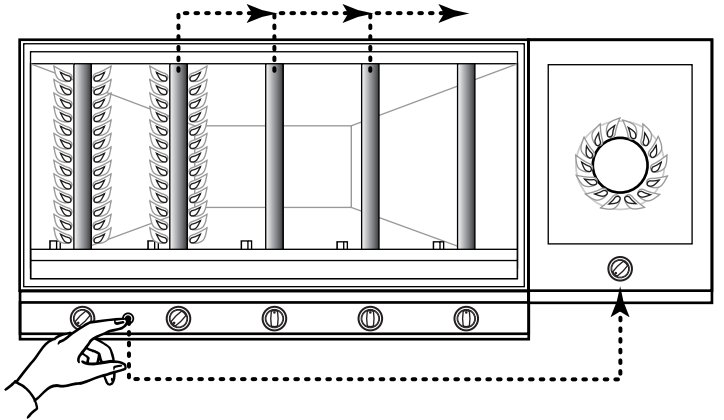

### COOKING WITH HOOD OPEN

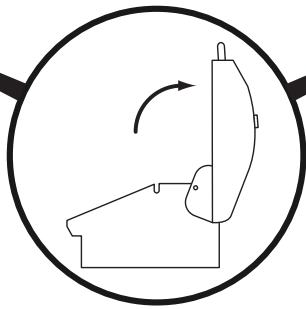
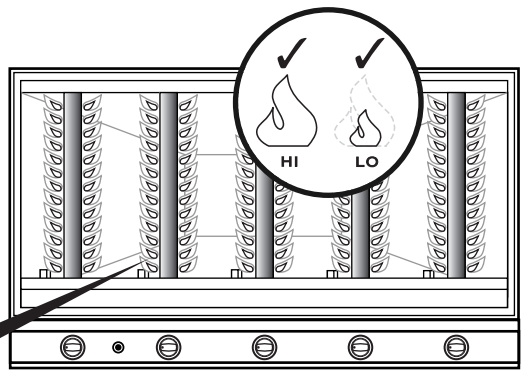
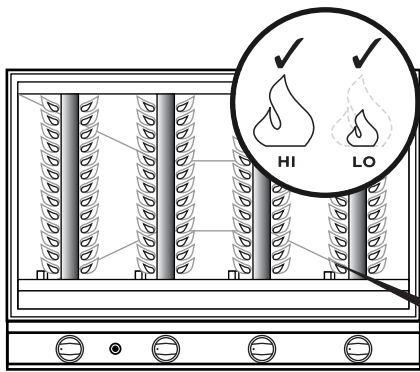

### COOKING WITH HOOD DOWN

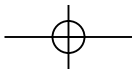
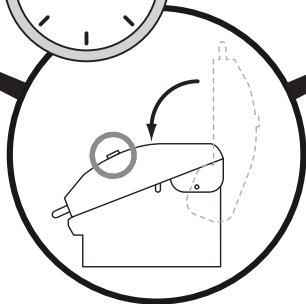
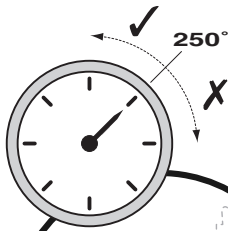
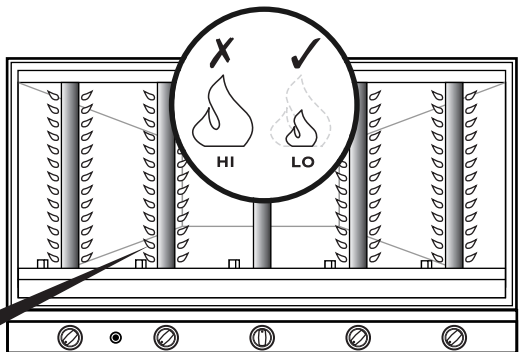
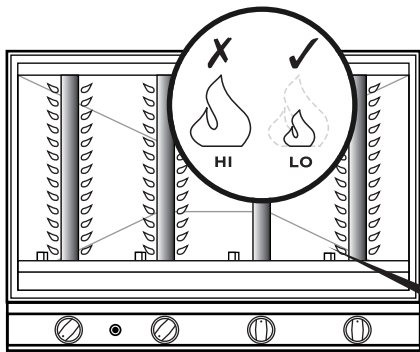

**INJECTOR**

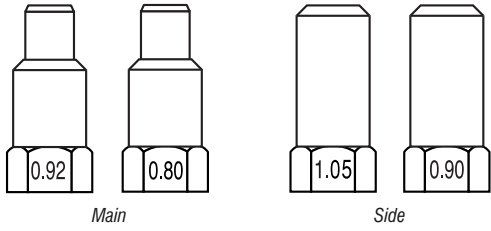

•Main	0.92 mm	- I 3+ (28-30/37)
		- I 3B/P (30)
	0.80 mm	- I 3B/P (50)
•Side	1.05 mm	- I 3+ (28-30/37)
		- I 3B/P (30)
	0.90 mm	- I 3B/P (50)

**INPUT**

	Xenon 223, 225	Xenon 227, 229
•Main	14.8 kW – 1075 grams / h	18.5 kW – 1345 grams / h
•Side	4.5 kW – 327 grams / h	4.5 kW – 327 grams / h

**DIMENSIONS**

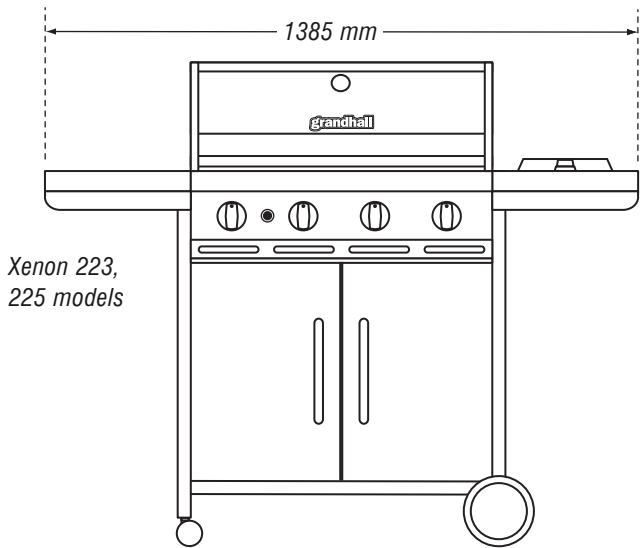

Xenon 223, 225 models

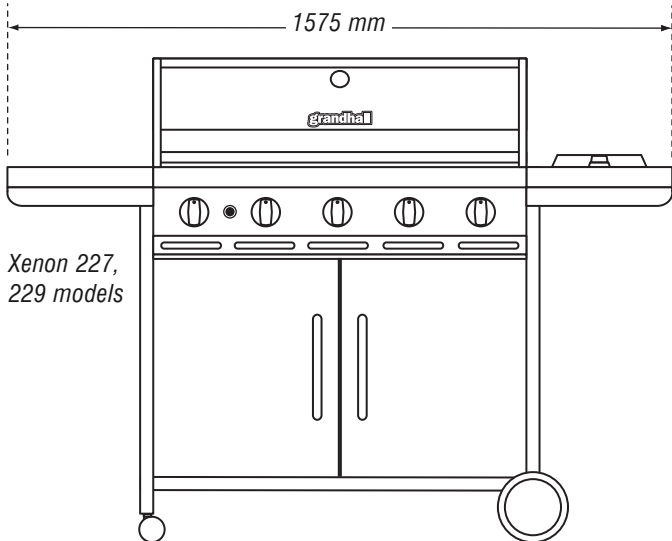

Xenon 227, 229 models

**WARNINGS INFORMATION**

- **MINIMUM CLEARANCES FROM COMBUSTIBLE MATERIALS MUST BE:**  
 REAR - 450 mm  
 SIDES - 250 mm  
 TOP - 1000 mm

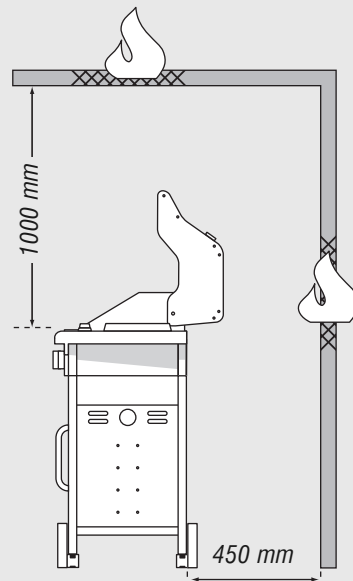
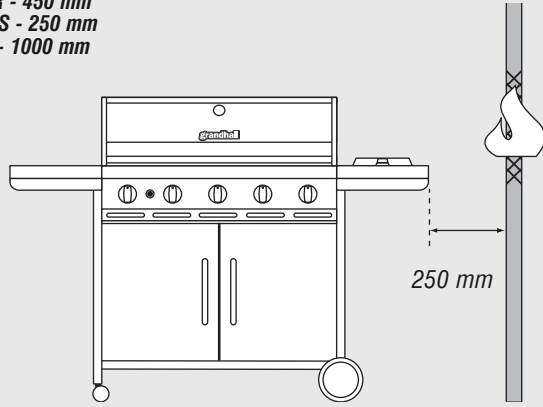

Xenon 223, 225, 227, 229 models

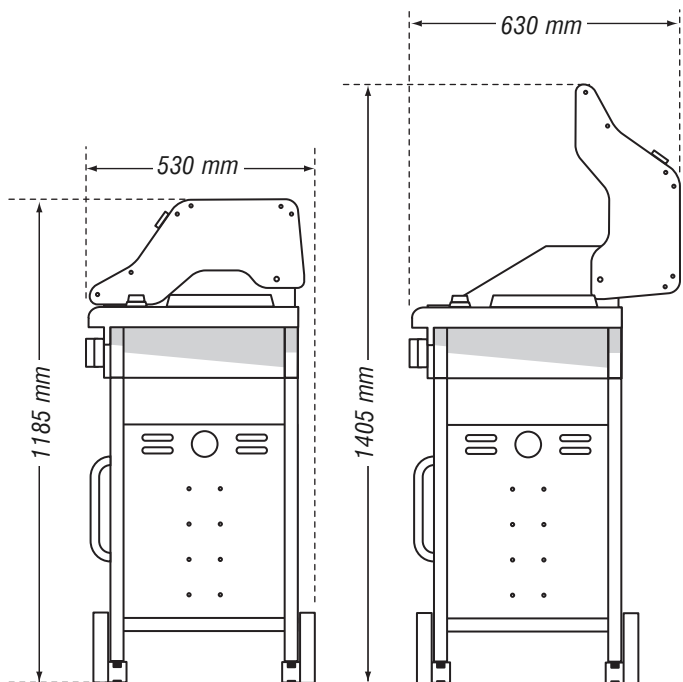

**PARTS LIST**

Ref	Description	Xenon 223 Part #	Qty	Xenon 225 Part #	Qty
1	Hood plate	P0014601FB	1	P0014610EA	1
2	Hood side panel – right	P0010607DJ	1	P0010607DJ	1
3	Hood side panel – left	P0010506DJ	1	P0010506DJ	1
4	Hood trim plate	-	-	P0011456QJ	1
5	Hood handle	P00205072B	1	P00205072B	1
6	Hood handle heat-insulating spacer	P06801001A	2	P06801001A	2
7	Protective pad	P05518003I	2	P05518003I	2
8	Temperature gauge	P00601421B	1	P00601421B	1
9	Name plate	P00407006S	1	P00407006S	1
10	Cooking rack / secondary	P01504001E	1	P01504001E	1
11	Grill plate	P01602008F	3	P01602008F	3
12	Flame tamer	P01705019F	4	P01705019F	4
13	Burner – main	P020080184	4	P020080184	4
14	Burner bracket	P02213003B	1	P02213003B	1
15	Cross lighter – 30 mbar – 50 mbar	P02626001A P02626002A	2 2	P02626001A P02626002A	2 2
16	Gas collector with electrode – 30 mbar – 50 mbar	P02608005A P02608057A	1 1	P02608005A P02608057A	1 1
17	Electronic wire set	P02615084A	1	P02615084A	1
18	Electronic igniter – 2 port	P02502252C	1	P02502252C	1
19	Bowl panel – right	P00721324A	1	P00721324A	1
20	Bowl panel – left	P00720304A	1	P00720304A	1
21	Bowl panel – front	P0073826GA	1	P0073826GA	1
22	Bowl panel – rear	P0072547GA	1	P0072547GA	1
23	Control panel – with screen print, 30 mbar	P0290619E5	1	P0290621E5	1
23	Control panel – with screen print, 50 mbar	P0290620E5	1	P0290622E5	1
24	Gas valve manifold assembly – 30 mbar	Y0060345	1	Y0060345	1
24a	Gas valve manifold assembly – 50 mbar	Y0060346	1	Y0060346	1
24b	Gas jet – main, 30 mbar	P06519052A	4	P06519052A	4
24c	Gas jet – main, 50 mbar	P06519053A	4	P06519053A	4
24d	Heat shield	P03006116B	1	P03006116B	1
25	Grease draining tray	P02717147B	1	P02717147B	1
26	Control knob – main burner	P03419423R	4	P03419423R	4
27	Grease receptacle	P02701087B	1	P02701087B	1
28	Side shelf – left	P01102040C	1	P01102040C	1
29	Side burner frame	P01104039C	1	P01104039C	1
30	Gas valve – side burner without jet, 1/4" LH	P03222118J	1	P03222118J	1
30a	Gas jet – side burner, 30 mbar – side burner, 50 mbar	P06533010A P06533011A	1 1	P06533010A P06533011A	1 1
31	Control knob – side burner	P03426093M	1	P03426093M	1
32	Side burner with brass ring	P02002007A	1	P02002007A	1
33	Side burner electrode	P02607007A	1	P02607007A	1
34	Side burner lid	P0011503IK	1	P0011503EA	1
35	Side burner pot support	P00805013B	1	P00805013B	1
36	Side burner hose	P03711005A	1	P03711005A	1
37	Bowl support bracket – left	P01304006D	1	P01304006D	1
38	Bowl support bracket – right	P01305010D	1	P01305010D	1
39	Door bracket	P03305025D	1	P03305025D	1
40	Trolley leg – left-front castor side	P00910008C	1	P00910008C	1
41	Trolley leg – left-back castor side	P00911010C	1	P00911010C	1
42	Trolley leg – right-front wheel side	P00912008C	1	P00912008C	1
43	Trolley leg – right-back wheel side	P00913012C	1	P00913012C	1
44	Trolley bottom shelf – with cylinder hole	P01002049D	1	P01002049D	1
45	Trolley side panel – left	P07605007B	1	P07605007B	1
46	Trolley side panel – right	P07606018B	1	P07606018B	1
48	Castor – 3" with brake	P05106004A	2	P05106004A	2
49	Wheel	P05101001A	2	P05101001A	2
50	Wheel hub cap	P05122001A	2	P05122001A	2
51	Door	P04304014B	2	P04301025A	2
52	Door trim plate	P07510021B	2	P07510021B	2
53	Door magnet	P05318022B	2	P05318022B	2
54	Door spacer	P06801016G	4	P06801016G	4
55	Door handle	P00203009B	2	P00203009B	2
58	Door stop plate	P05523003G	1	P05523003G	1
59	Gas cylinder strap	P05314001V	1	P05314001V	1
60	Frame for gas cylinder	P04021009C	1	P04021009C	1
61	Gas cylinder bracket	P03327020D	1	P03327020D	1
62	Universal hose barb – 1/4" LH	P03901024A	1	P03901024A	1
	Hardware pack	P06028013A	1	P06028013A	1
	Operations manual	P80184012K	1	P80184012K	1

**PARTS DIAGRAM – Xenon 223, 225**

This diagram is provided to assist you identify parts if replacement is necessary. Contact your place of purchase to enquire about parts, availability and or service.

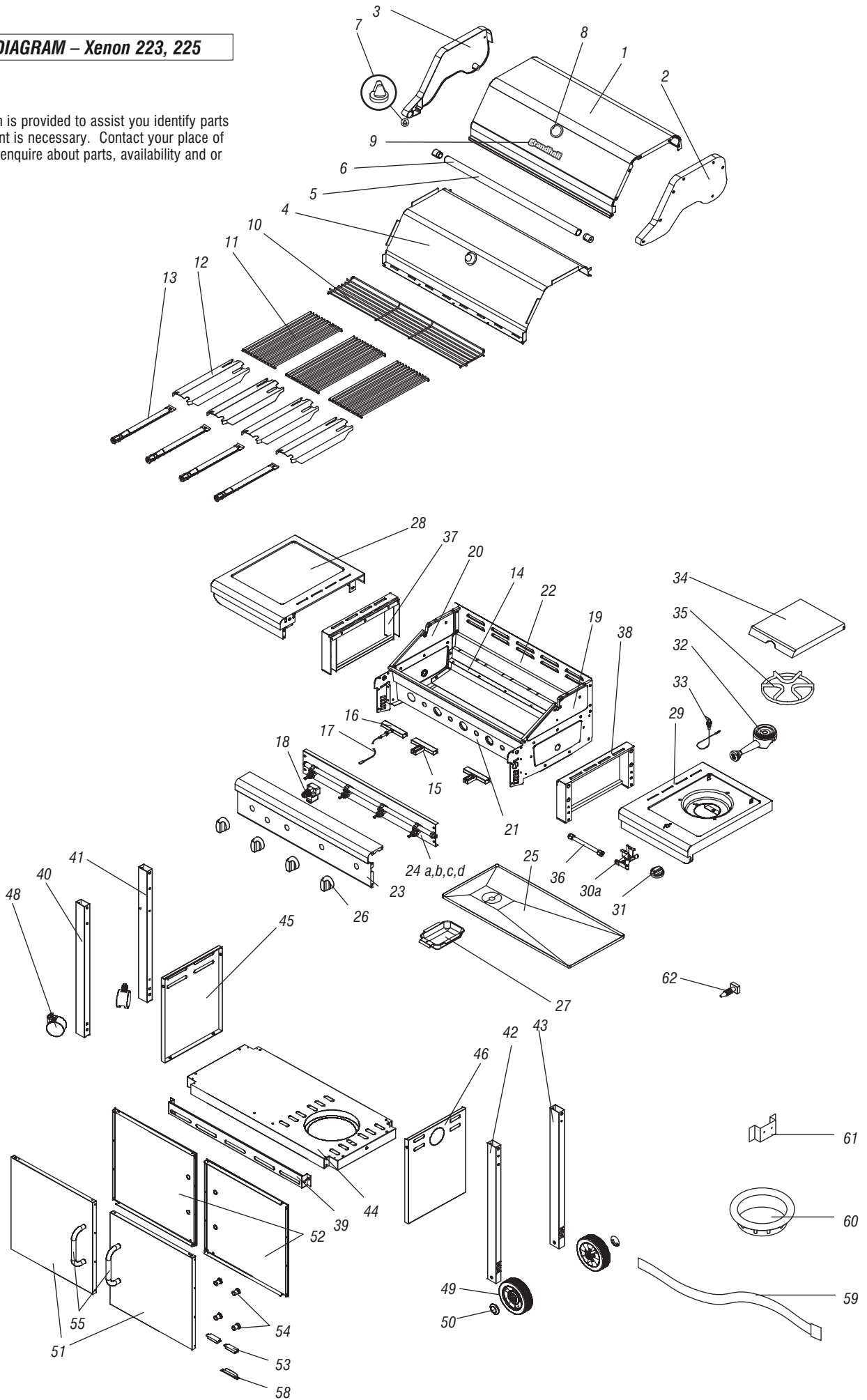

**PARTS LIST**

Ref	Description	Xenon 227 Part #	Qty	Xenon 229 Part #	Qty
1	Hood plate	P0014611FB	1	P0014710EA	1
2	Hood side panel – right	P0010607DJ	1	P0010607DJ	1
3	Hood side panel – left	P0010506DJ	1	P0010506DJ	1
4	Hood trim plate	-	-	P0011456QJ	1
5	Hood handle	P00205071B	1	P00205071B	1
6	Hood handle heat-insulating spacer	P06801001A	2	P06801001A	2
7	Protective pad	P05518003I	2	P05518003I	2
8	Temperature gauge	P00601421B	1	P00601421B	1
9	Name plate	P00407006S	1	P00407006S	1
10	Cooking rack / secondary	P01506001E	1	P01506001E	1
11	Grill plate	P01602008F	4	P01602008F	4
12	Flame tamer	P01705019F	5	P01705019F	5
13	Burner – main	P020080184	5	P020080184	5
14	Burner bracket	P02213043B	1	P02213043B	1
15	Cross lighter – 30 mbar – 50 mbar	P02626001A P02626002A	3 3	P02626001A P02626002A	3 3
16	Gas collector – with electrode, 30 mbar – with electrode, 50 mbar	P02608005A P02608057A	1 1	P02608005A P02608057A	1 1
17	Electronic wire set	P02615085A	1	P02615085A	1
18	Electronic igniter – 2 port	P02502252C	1	P02502252C	1
19	Bowl panel – right	P00721324A	1	P00721324A	1
20	Bowl panel – left	P00720304A	1	P00720304A	1
21	Bowl panel – front	P0073825GA	1	P0073825GA	1
22	Bowl panel – rear	P0072546GA	1	P0072546GA	1
23	Control panel – with screen print, 30 mbar – with screen print, 50 mbar	P0290822E5 P0290823E5	1 1	P0290824E5 P0290825E5	1 1
24	Gas valve manifold assembly – 30 mbar – 50 mbar	Y0060347 Y0060348	1 1	Y0060347 Y0060348	1 1
24a	Gas valve – main without jet	P03234074D	5	P03234074D	5
24b	Gas jet – main 30 mbar – main 50 mbar	P06519052A P06519053A	5 5	P06519052A P06519053A	5 5
24c	Heat shield	P03008176B	1	P03008176B	1
24d	Manifold tube	P05008142A	1	P05008142A	1
25	Grease draining tray	P02717137B	1	P02717137B	1
26	Control knob – main burner	P03419423R	5	P03419423R	5
27	Grease receptacle	P02701087B	1	P02701087B	1
28	Side shelf – left	P01102040C	1	P01102040C	1
29	Side burner frame	P01104039C	1	P01104039C	1
30	Gas valve – side burner without jet	P03222118J	1	P03222118J	1
30a	Gas jet – side burner 30 mbar – side burner 50 mbar	P06533010A P06533011A	1 1	P06533010A P06533011A	1 1
31	Control knob – side burner	P03426093M	1	P03426093M	1
32	Side burner with brass ring	P02002007A	1	P02002007A	1
33	Side burner electrode	P02607007A	1	P02607007A	1
34	Side burner lid	P0011503IK	1	P0011503EA	1
35	Side burner pot support	P00805013B	1	P00805013B	1
36	Side burner hose	P03711005A	1	P03711005A	1
37	Bowl support bracket – left	P01304006D	1	P01304006D	1
38	Bowl support bracket – right	P01305010D	1	P01305010D	1
39	Door bracket	P03305024D	1	P03305024D	1
40	Trolley leg – left-front castor side	P00910008C	1	P00910008C	1
41	Trolley leg – left-back castor side	P00911010C	1	P00911010C	1
42	Trolley leg – right-front wheel side	P00912008C	1	P00912008C	1
43	Trolley leg – right-back wheel side	P00913012C	1	P00913012C	1
44	Trolley bottom shelf – with cylinder hole	P01004049D	1	P01004049D	1
45	Trolley side panel – left	P07605007B	1	P07605007B	1
46	Trolley side panel – right	P07606018B	1	P07606018B	1
48	Castor – 3" with brake	P05106004A	2	P05106004A	2
49	Wheel	P05101001A	2	P05101001A	2
50	Wheel hub cap	P05122001A	2	P05122001A	2
51	Door	P04304015B	2	P04301024A	2
52	Door trim plate	P07510022B	2	P07510022B	2
53	Door magnet	P05318022B	2	P05318022B	2
54	Door spacer	P06801016G	4	P06801016G	4
55	Door handle	P00203009B	2	P00203009B	2
58	Door stop plate	P05523003G	1	P05523003G	1
59	Gas cylinder strap	P05314001V	1	P05314001V	1
60	Frame for gas cylinder	P04021004C	1	P04021004C	1
61	Gas cylinder bracket	P03327020D	1	P03327020D	1
62	Universal hose barb – 1/4" LH	P03901024A	1	P03901024A	1
	Hardware pack	P06028013A	1	P06028013A	1
	Operations manual	P80184012K	1	P80184012K	1

**PARTS DIAGRAM – Xenon 227, 229**

This diagram is provided to assist you identify parts if replacement is necessary. Contact your place of purchase to enquire about parts, availability and or service.

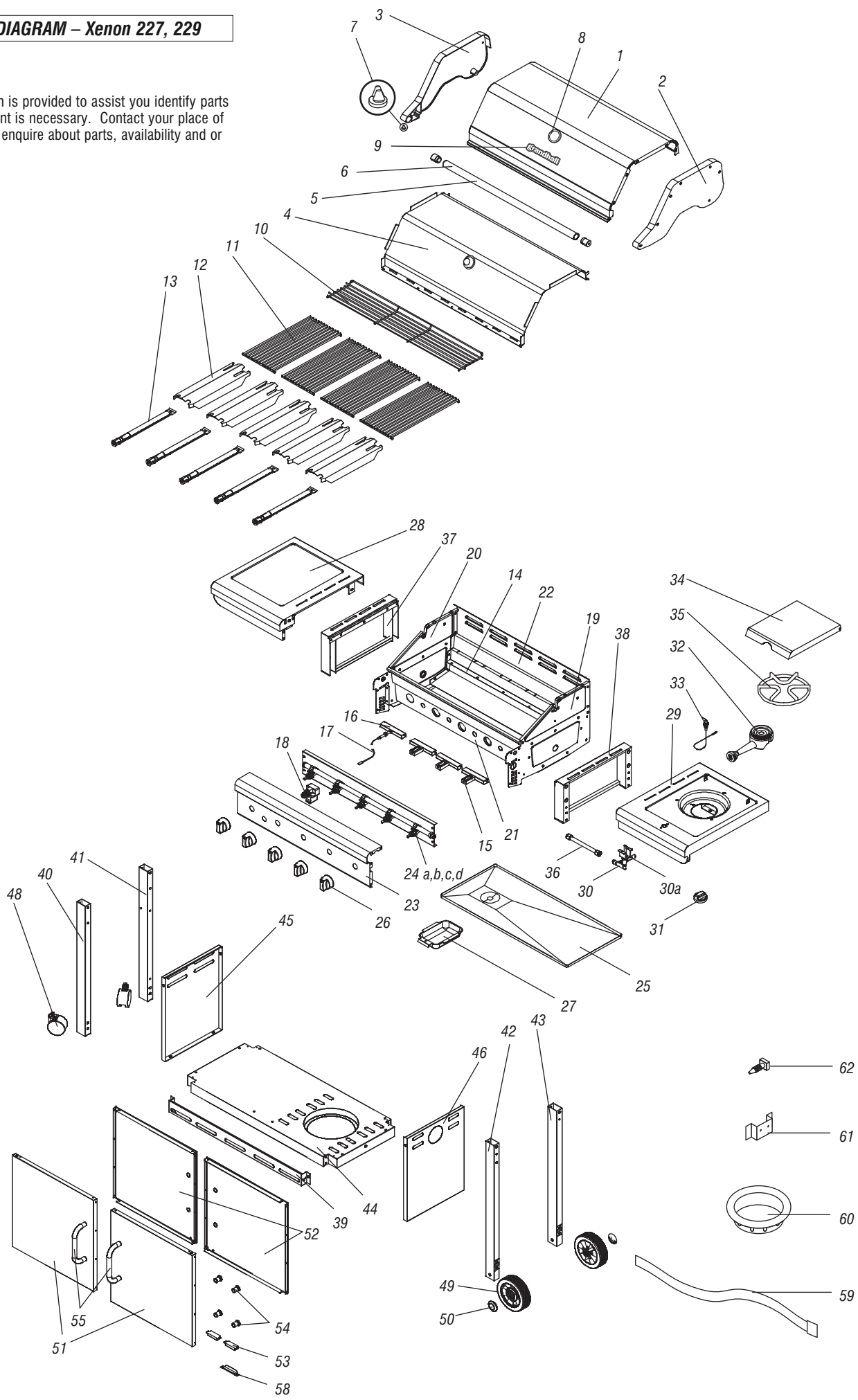

**SERVICE**

service@grandhall.eu

Grand Hall Europe  
PO Box 431  
7570 AK Oldenzaal  
The Netherlands

T: +31 (0) 541 531669  
F: +31 (0) 541 534563

www.grandhall.eu

**(IE) (GB) NOTE:** This information is a guide only. Items included in your BBQ specification may differ depending on region or specific dealer specification.

**(CH) (FR) NOTE:** Ces renseignements sont donnés à titre indicatif. Il est possible que les articles inclus dans les spécifications de votre barbecue diffèrent selon la région ou les caractéristiques stipulées par le concessionnaire.

**(AT) (CH) (DE) ANMERKUNG:** Diese Anleitung dient nur zu Informationszwecken. Einzelteile der Grillspezifikation sind unter Umständen verschieden entsprechend der Vertriebsregion oder bestimmten Händleranforderungen.

**(CH) (IT) AVVERTENZA:** Queste informazioni hanno il valore di guida soltanto. Gli articoli compresi nelle caratteristiche tecniche del barbecue potrebbero variare a seconda della regione o del concessionario.

**(LU) (BE) (NL) ATTENTIE:** Deze informatie is alleen bedoeld als gids. Onderdelen in uw BBQ specificatie en pakket kunnen per regio of per dealer verschillen.

**(SE) ANM.:** Denna information är endast avsedd som handledning. Specifikationerna för grillen kan variera regionalt eller beroende på de krav som olika återförsäljare har.

**(FI) HUOMATKAA:** Nämä tiedot ovat pelkästään suuntaa antavia. Ostamanne grillin yksityiskohdat voivat olla erilaiset paikkakunnan tai erityisten myyjäkohtaisten yksityiskohtien mukaan.

**(ES) NOTA:** Esta información es una guía únicamente. Es posible que las indicaciones incluidas en las especificaciones de su Asador sean diferentes según la región o las especificaciones específicas del representante.

**(PT) NOTA:** Esta informação é simplesmente um guia. Os itens incluídos na especificação do seu BBQ poderão diferir dependendo da especificação da região ou do vendedor específico.

**(DK) NB:** Denne information er kun vejledende. Specifikationer kan variere efter ønske fra forhandler, eller i henhold til nationale regler.

**(NO) NB:** Denne informasjon er kun veiledende. Spesifikasjoner kan variere som stipulert av forhandler, eller i henhold til nasjonale krav.

**(PL) UWAGA:** Informacje te służą jedynie, jako wskazówki. Elementy wchodzące w skład specyfikacji twojego grilla mogą się różnić w zależności od regionu lub szczególnych specyfikacji dealera.

*All specifications are subject to change without notice.*

*Toutes les caractéristiques sont susceptibles d'être modifiées sans préavis.*

*Änderungen ohne vorherige Bekanntgabe vorbehalten.*

*Tutti i dati tecnici possono cambiare senza preavviso.*

*Alle specificaties kunnen zonder voorafgaande kennisgeving worden gewijzigd.*

*Kaikki oikeudet teknisten tietojen muutoksiin pidätetään.*

*Kaikki yksityiskohdat voivat muuttua ilman, että niistä erikseen ilmoitetaan.*

*Todas las especificaciones están sujetas a cambios sin previo aviso.*

*Todas as especificações estão sujeitas a alteração sem aviso.*

*Alle specifikationer kan ændres foruden varsel.*

*Spesifikasjoner kan endres uten varsel.*

*Wszystkie specyfikacje mogą ulec zmianie bez uprzedzenia.*

Manufacturer:

Grand Hall Enterprises Co. Ltd.  
9th Fl. No 298 Rueiguang Rd  
Neihu, Taipei, Taiwan

P80181013K Printed 10/2009

